



# Data Sheet 605.30

## In- and outlet for SU/SO/SUH/SAU

### Accessories: In-and outlet

As standard, the following in-and outlets exist for the Cimbría conveyor program

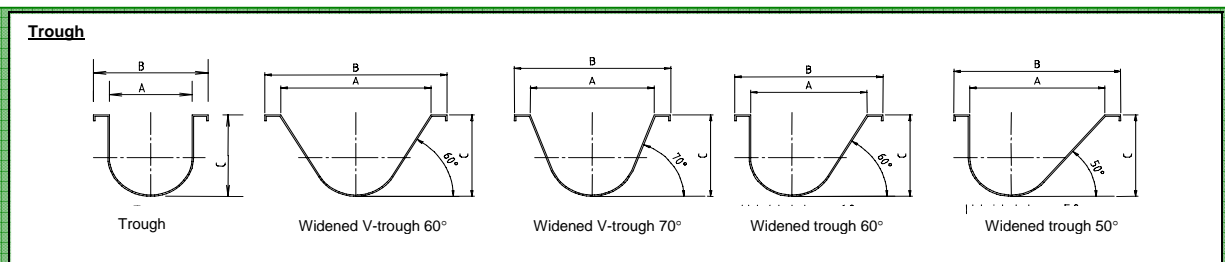

SU - SUH	150	200	250	300	350	400	450	500
A	166	216	266	320	370	420	470	520
B	230	280	330	384	464	518	568	622
C	181	231	284	338	388	440	490	542
Widened V-trough 60°								
C	281	334	388	438	490	540	592	642
A	446	536	626	716	804	890	978	1066
B	510	600	690	780	870	960	1050	1140
Widened V-trough 70°								
C	281	334	388	438	490	540	592	642
A	353	427	502	576	648	719	791	863
B	417	489	566	648	726	807	889	971
Widened trough 60°								
C	281	334	388	438	490	540	592	642
A	331	401	473	543	612	680	749	818
B	395	465	537	606	676	746	815	885
Widened trough 50°								
C	281	334	388	438	490	540	592	642
A	391	473	556	636	716	794	874	954
B	455	537	620	702	784	864	944	1024

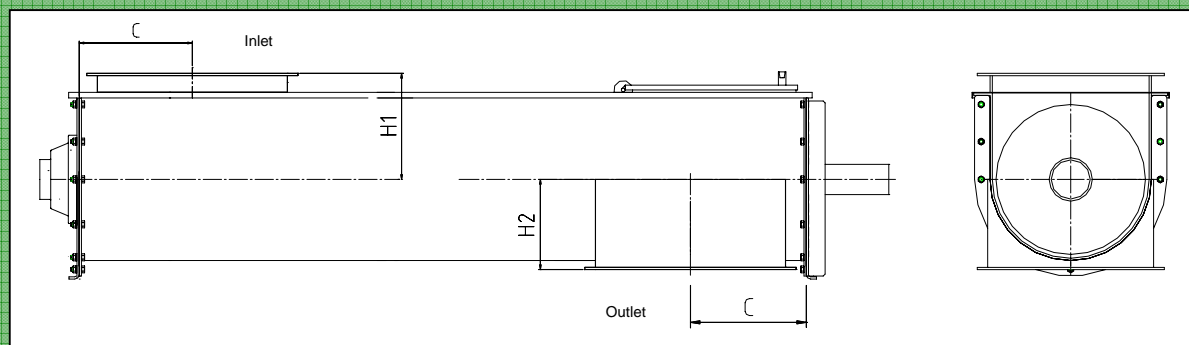

SU - SUH SO - SAU		150	200	250	300	350	400	450	500
Flange in-and outlet	A	300	300	400	400	450	500	550	600
	B	178	228	278	332	382	436	486	540
	C	350	350	450	450	510	560	610	660
	D	228	278	328	382	442	496	540	600
	E	100	55	69	69	72	72	72	130
	F	1 x 150	2 x 120	2 x 156	2 x 156	2 x 183	2 x 208	2 x 233	2 x 200
	G	58	58	89	101	121	123	123	170
	H	1 x 112	1 x 162	1 x 150	1 x 180	1 x 200	1 x 250	1 x 300	1 x 260
	J	10	10	10	10	15	15	15	15
	K	8 x Ø10	10 x Ø10	10 x Ø10	10 x Ø10	10 x Ø10	10 x Ø10	10 x Ø10	10 x Ø10
	Q-tube and Q-flange	P	Q16	Q16 Q20	Q20 Q24	Q24	Q24		
Q		180	180 220	200 260	260	320			
		160	160 200	200 240	240	300			
R					Q30	Q30	Q30	Q30	Q30
S					300	300	300	300	300
T					350	350	350	350	350
					108	108	108	108	108
Placing in-and outlet		C		200	250	250	275	300	325
H1		172	200	227	252	278	298	329	
H2		131	149	176	201	228	253	285	